

Bear Bones Systems Motono Dirt Bike Platform User's Manual

Bear-Bones.com

Patents Pending

Version 1.0 _1/18/19



Table of Contents

1. MOTONO PLATFORM INTRODUCTION
2. SAFETY
3. USING THE MOTONO PLATFORM
4. CAPACITY



WARNING

Please read and understand the information in this User's Manual to help avoid possible damage, injury or death that could result from failure to follow these instructions and heed these warning.

1. MOTONO PLATFORM INTRODUCTION

Thank you for purchasing a Motono Dirt Bike platform a part of the Bear Bones System's family of products. The Motono platform is used to lift dirt bikes for storage or for conveniently positioning a bike for maintenance or servicing.

2. SAFETY

- 2.1. Never place your body beneath a suspended load.
- 2.2. Never exceed the weight capacity of the Motono Platform which is 400lbs
- 2.3. Be aware of the general envelope of the bike being lifted to avoid collisions with surrounding items or ceilings.
- 2.4. Use the included foot peg fasteners to keep the bike from tipping forward. If your bike happens to sit on the Motono platform in a way that allows it to rock to the rear, use a tie down strap to secure the front of the bike's frame to the front cross channel of the Motono platform.

3. USING THE MOTONO PLATFORM

1. To lift one dirt bike or the first dirt bike with the Motono Platform, lower the empty carriage using the hoist until the top of the receiver tube is below the height of the belly of the bike.
2. Position the dirt bike in front of the Ascension column with the center of the engine roughly aligned with the center of the column and the center of the bike roughly 15" from the front of the Ascension column.
3. Lean the bike's handlebar against the wall and insert the Motono Platform into the carriage receiver completely or until the hole in the Motono aligns with the hole in the receiver.

4. Stand the bike up and reposition it so that it is centered on the wood pad and the slots in the cross channel of the Motono Platform align with the foot pegs.



5. Raise the carriage using the hoist until the Motono Platform begins to lift the bike off the floor.
6. Insert the foot peg fasteners up through the slots in the cross channel and through the foot pegs. Then place the foot peg washers and knobs over the fasteners and screw the knobs down until they just start to pull on the pegs. These foot peg fasteners are merely a safety feature to ensure that the dirt bike doesn't rock forward and should not be tightened beyond contact with the pegs. If you find that your bike can rock backwards or for extra security, use a tie down strap to secure the front of the frame to the front cross channel of the Motono Platform.
7. Raise the carriage to the desired height using the hoist while making sure you don't crash the bike into the ceiling.
8. Removing the bike is the reverse operation.
9. **To lift more than one dirt bike**, load the first as described in steps 1-9 above. Then with the first bike lifted, hang a fully extended carriage tie strap from the bottom loop of the first carriage with the short end up. Then add a



carriage assembly onto the column by orienting it horizontally while passing the upper rollers through the rail cutouts located near the bottom. Then raise it up and pass the lower rails through the cutouts. Lift it up the column and attach the carriage tie strap to its upper loop.

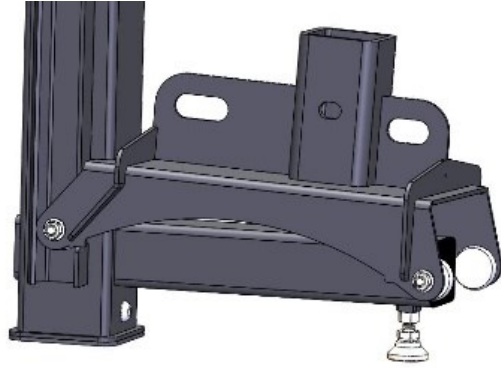

10. Place a 1"-2" spacer block on the column leg beneath the carriage so that the carriage can't go low enough for the lower rollers to pop out of the cutouts in the rails.
11. Position the dirt bike to be loaded as in step 2 above and lean the handlebar against the wall. Then lower the carriages with the hoist until you achieve the desired spacing between the bikes. Insert the Moton Platform into the receiver as before and then from the back side lift the carriage by hand while removing the slack from the carriage tie strap.
12. Continue as in steps 4-7 above.
13. Hint: Once you have found the correct location for loading bike/s, marking the floor can make loading the bike/s simpler next time.
14. Hint: An organized person might install hooks on the wall near their Ascension Minimalift to conveniently hang carriages and platforms as they are removed from the lift.

4. CAPACITY

The Moton Platform is rated for 400lbs